

1 Remove the inner rail

1 Pull tab forward and take out inner rail.

2 Push and slide middle rail back.

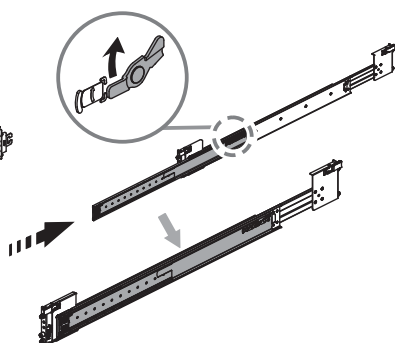
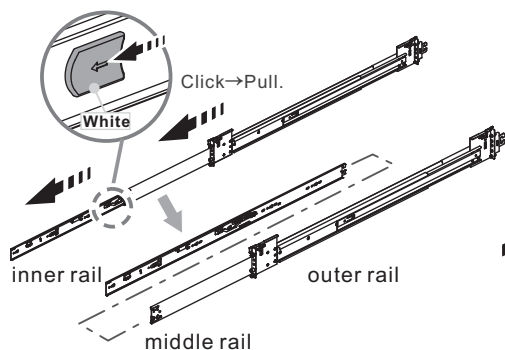

2 Check hole type on rack post

**Check hole type on rack post. Choose suitable pin of bracket to install if needed.

Ⓒ 9.5 Square Hole (Pre-installed)

For 9.5 Square hole frame : Install slide rail as usual.

Ⓒ 7.1 Round Hole

For 7.1 Round hole frame : Please refer to the manual : Replacing the suitable pin.

Ⓘ M5 Bracket Screw (Pre-Installed)

Front bracket

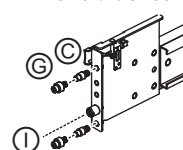

Rear bracket

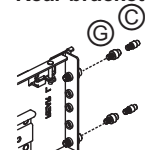

SCREW SACK

Ⓐ M4x4L-P0.7	Inner rail	⊕	⏏
Ⓑ #6-32x4L	Inner rail	⊕	⏏
Ⓒ Round hole pin	For Ø7.1 Round Hole	⊕	⏏
Ⓓ #10-32x13L	For #10-32 Thread Hole	⊕	⏏
Ⓔ M5x9.0L-P0.8	For Shipping	⊕	⏏
Ⓕ M3x4.0L-P0.5	For CMA BKT	⊕	⏏

3 Install the inner rail onto the chassis

• Detach inner rail from standoff

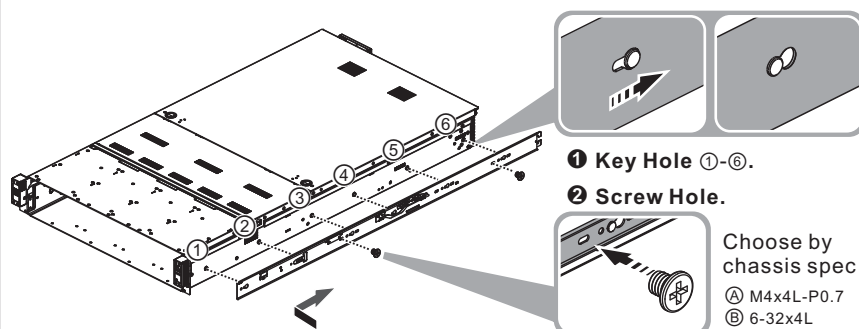

1 Loosen screw.

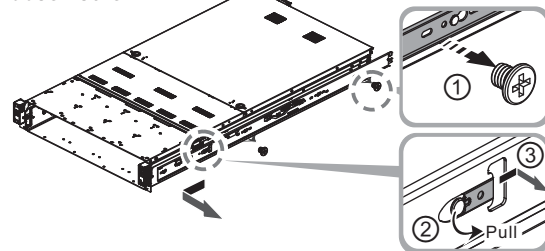

2 Pull the latch upward and remove the keyhole from standoff and slide inner rail forward to remove inner rail.

4 Fix the outer rail/bracket assembly to the frame

• Detach bracket from rack post

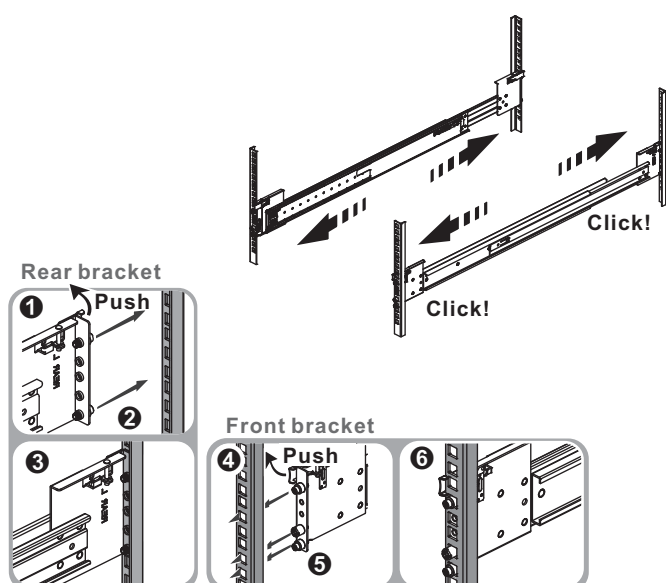

* Please repeat installation steps for the other side.

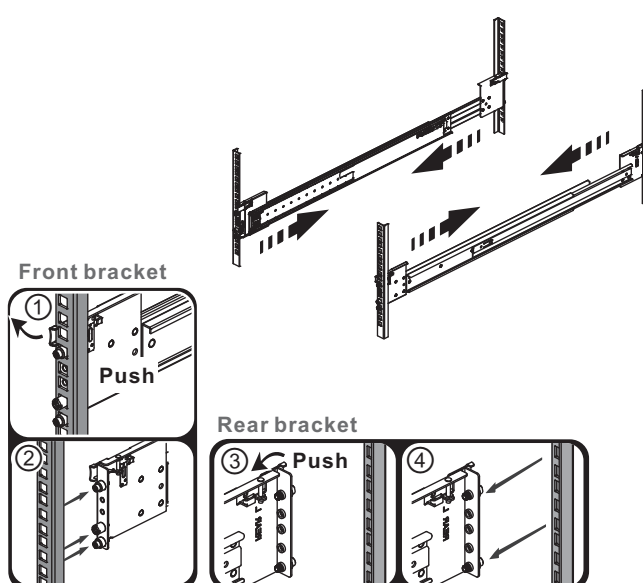

* Please repeat the detached steps for the other side.

5 Insert the chassis to complete the installation

- 1 2 Pull the middle rails fully extended in lock position, ensure ball bearing retainer is located at the front of the middle rails.
- 3 Horizontally insert the chassis into middle-outer rails.
- 4 5 When hit a stop, please pull/push the blue release tab on the inner rails.
- 6 Tighten chassis with shipping screws.

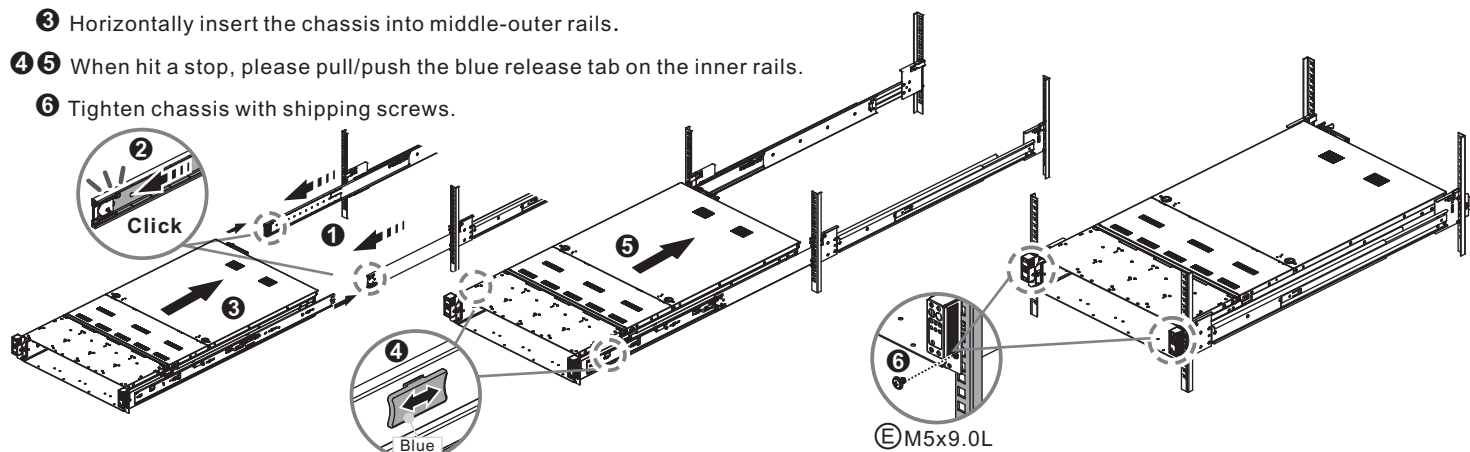

Remove the chassis from rack

- 1 2 Loosen shipping screws to pull out chassis.
- 3 4 Pull the disconnect tab forward to remove chassis at the full extension position.

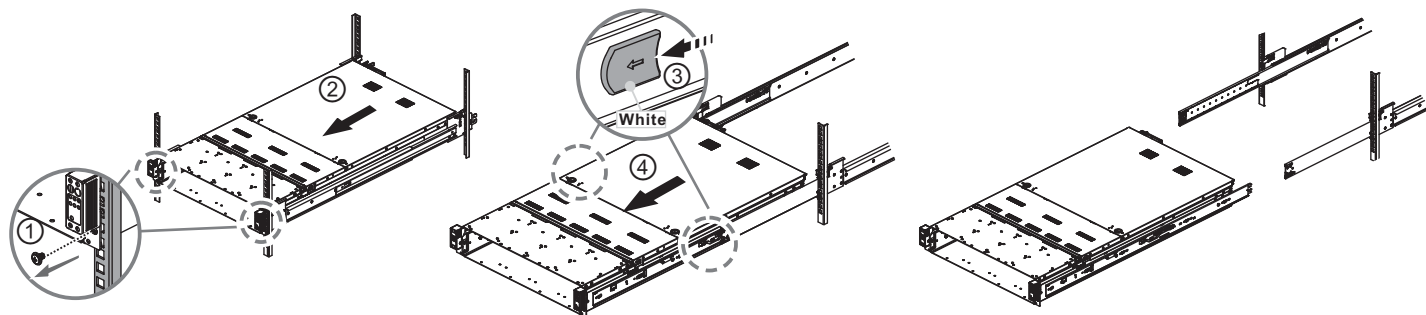

Install in #10-32 rack

- 1 Remove pins for square and round hole rack. Remove nut on the bracket.
- 2 3 4 Use #10-32 screw in the accessory bag, then fasten nut on the rack post.

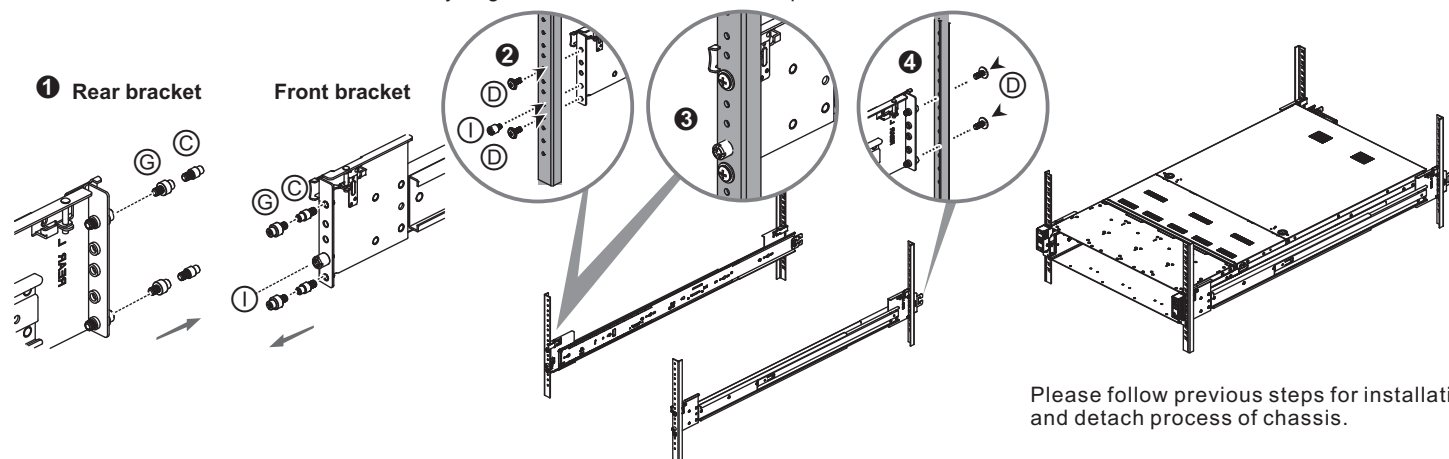

Accessory for CMA bracket

When using CMA, please use the accessory.
It is OK not to use accessory when no CMA requirements.

